



ICC Pei LLC is an accredited ISO Standard 17065 Product Certifier, accredited by the A2LA. This **Product Evaluation Report** represents a product that ICC PEI LLC has Evaluated. This product has a Product Evaluation Service Agreement & Follow-up Inspection Service Agreement. This **Product Evaluation Report** in no way implies warranty for this product or relieves [The Dow Chemical Company](#) of their liabilities for this product. This **PER** is an official document if it is within one year of the initial or re-approval date.

Initial Approval
January, 2002

Re-Approved
March, 2021

See all **ICC Pei** reports at: www.p-e-i.com

Report Owner

The Dow Chemical Company
1881 West Oak Parkway
Marietta, GA 30062

Approved Manufacturing Locations

The Dow Chemical Company
1881 West Oak Parkway
Marietta, GA 30062

Product

Voramer MB 3022 Polyol Two-Part
Polyurethane Foam Adhesive

Evaluation Report Information

www.dow.com
DOW Contact: Shawn George - (678) 832-7077

General Details

Voramer MB 3022 adhesive is used to bond wood framing to gypsum in ceiling and wall construction without the use of mechanical fasteners. The manufacturing location listed above has an approved Quality Assurance Manual to manufacture the **Voramer MB 3022** Polyol Two-Part Polyurethane Adhesive and is inspected quarterly by **ICC Pei LLC** (formerly Progressive Engineering Inc).

Product Description

Voramer MB 3022 is a two-part polyurethane foam adhesive system. It is applied by pumping two components at a 1 to 1 volumetric ratio under pressure through heating equipment to produce one continuous bead. The two components are comprised of "**Voramer MB 3022** Polyol" and "Voramer ME 3044 Isocyanate". The Voramer ME 3044 ISO is a pre-mixed standard material shipped from a supplier and the **Voramer MB 3022** Polyol is manufactured by The Dow Chemical Company. This adhesive does not off-gas Formaldehyde into the air.

Containers and Storage

The A & B components are shipped in 250 gallon disposable totes, 55 gallon steel drums and 350 returnable tanks. Storage of these containers shall be in an indoor conditioned place between 70°F. and 90°F. Unopened containers will have a storage life of up to six months in these conditions.

General Product Use and Limitations

The gypsum board being used shall in compliance with ASTM C 1396 and be clean and dry with loose dust blown off and free from liquids, oil, grease, etc. Recommended gypsum temperature is greater than 50°F. **Voramer MB 3022** Polyol adhesive shall be applied in an ambient temperature range of 50°F to 100°F. The adhesive is applied along the intersection of the vertical plane of the wooden member and the horizontal plane of the gypsum board according to The Dow Chemical Company Application Instructions. The adhesive temperature at the heater block and hose shall be between 90°F. and 115°F. After the last bead is applied, the structure shall not be moved for a minimum of two minutes. The structure shall stay in the same ambient conditions for the first 24 hours.

Voramer MB 3022 adhesive can be used on a maximum wood frame spacing of 16" o.c. for walls and 24" o.c. for ceiling applications. The fillet beads produced shall be sized per Figure 1 and per Table 1, Note 1 for wall shear design values. A bead shall never be greater than 1" in size. The adhesive beads are applied along one side of field framing and along both sides at gypsum seams. A bead shall never be greater than 1-1/2" in width.

- The **Voramer MB 3022** adhesive shall be installed according to The Dow Chemical Company Application Instructions. A copy of these instructions must be made easily available at the assembly areas.
- This Evaluation is for **Voramer MB 3022** to be applied in an indoor manufacturing facility and is not meant to be applied in an outdoor uncontrolled environment.
- **Voramer MB 3022** adhesive is to be manufactured at The Dow Chemical Company plant in Marietta, GA following their approved quality assurance program with unannounced inspections by **ICC Pei LLC** (formerly *Pei*).
- The use of **Voramer MB 3022** adhesive in a fire rated assembly is not within the scope of this **PER**.
- A vapor barrier cannot be used between the adhesive and the substrates.
- **Voramer MB 3022** is to be applied to the back side standard raw gypsum and is not intended for other gypsums such as foil backed, moisture resistant or water resistant gypsums.
- Construction of assemblies using **Voramer MB 3022** and their design values shall be as described in the following test reports.
- **Voramer MB 3022** adhesive shall not be used for insulation or be considered insulation.

Building Code Compliance

Must be used with an approved thermal barrier not less than 1/2" (12.7mm) gypsum wallboard or approved material equivalent in compliance with the requirements of the 2006 IRC, Section R314.4 and the 2009, 2012, 2015, 2018 and 2021 IRC, Section R316.4.

Must be used with an approved thermal barrier not less than 1/2" (12.7mm) gypsum wallboard or approved material equivalent in compliance with the requirements of the 2006, 2009, 2012, 2015, 2018 and 2021 IBC, Section 2603.4

This product should be submitted to the Code Official for approval as an alternative material when used as alternative fastening method for drywall to framing applications in accordance with Section 104.11 as referenced in the 2021 IRC and IBC.

The HUD Code does not require a thermal barrier for adhesives.

October, 2016 Texas Industrialized Housing and Buildings Administrative Rules - Section: 70.103. (c) (2)

NC Residential Code, 2012 Edition - Section R316.6

ASTM E84-01 - Class A Fire Rating: Flame Spread Index - 20 and Smoke Development Index - 145

Meets or exceeds Acceptance Criteria of UL-1715 for use with 3/8" Gypsum Wallboard after 15 Minute Exposure Requirements, where flames shall not extend to the extremities or through the doorway opening of the tested specimen.

Meets or exceeds Acceptance Criteria of UL-1715 for use with 1/2" Gypsum Wallboard after 15 Minute Exposure Requirements, where flames shall not extend to the extremities or through the doorway opening of the tested specimen.

Meets or exceeds Acceptance Criteria of UL-1715 for use with 5/8" Gypsum Wallboard after 15 Minute Exposure Requirements, where flames shall not extend to the extremities or through the doorway opening of the tested specimen.

Tested to

Pei Standard No. 89-1 - Simple Span Ceiling or Roof Diaphragm Shear Resistance Test Procedure for Manufactured Homes

Pei Standard No. 93-7 - Performance Requirements for Fastening Gypsum Board to Wood Framing using a Two-Part Urethane Adhesive

Pei Standard No. 93-8 - Ceiling Board Dead Load Test Procedure

Pei Standard No. 94-9 - Large Scale Ceiling Board Dead Load Test Procedure

ASTM C 557 - Standard Specification for Adhesives for Fastening Gypsum Wallboard to Wood Framing

ASTM E 72 - Standard Test Methods of Conducting Strength Tests of Panels for Building Construction

ASTM E 84 - Standard Test Method for Surface Burning Characteristics of Building Materials

UL-1715 - UL Standard for Safety Fire Test of Interior Finish Material

Test Reports for Voramer MB 3022 Adhesive

TABLE 1: Wall Shear Designs^{1,2}

Framing				Gypsum Orientation	Gypsum Brand	Single or Double Sided	Ultimate Load PLF ³	Test Report #
Top Plate	Bott. Plate	Studs	Stud Spacing					
1x3	1x3	2x3	16" o.c.	5/16" Vertical	GA-Pacific	Single	460.7	2000-2123
					Gold Bond	Single	529.4	2001-0631
2x4	2x4	2x4	16" o.c.	7/16" Vertical	OSB	Single	1250.0	2001-0666

Notes:

1. Bead sizes as described in each test report.
2. Tested in Accordance to ASTM E72 - Static Wall Racking Tests
3. Ultimate load does not include any required safety factors

Design Values

Ceiling Diaphragm Design Load = **219 plf** (11' 8" minimum width x 52'-0" Maximum diaphragm span)

Ceiling Dead Load Resistance = **11.7 psf**

Note:

Ceiling Diaphragm and Dead Load Resistance testing is valid for all gypsum boards listed below, as long as the gypsum manufactured maintains a third party product listing showing compliance to ASTM C1396.

Gypsum Brands Tested for ceiling use

- 5/16" Georgia-Pacific Gypsum Board
- 5/16" Gold Bond Gypsum Board
- 5/16" USG SHEETROCK® MH Gypsum Ceiling Panels
- 1/2" Georgia-Pacific Gypsum Board
- 1/2" American Gypsum Ceiling Board
- 1/2" USG Fiberock Brand MH Gypsum Fiber Board
- 1/2" CertainTeed ProRoc Interior Ceiling Board
- 5/8" USG SHEETROCK® Brand Firecode Type X Gypsum (Dead Load use only)

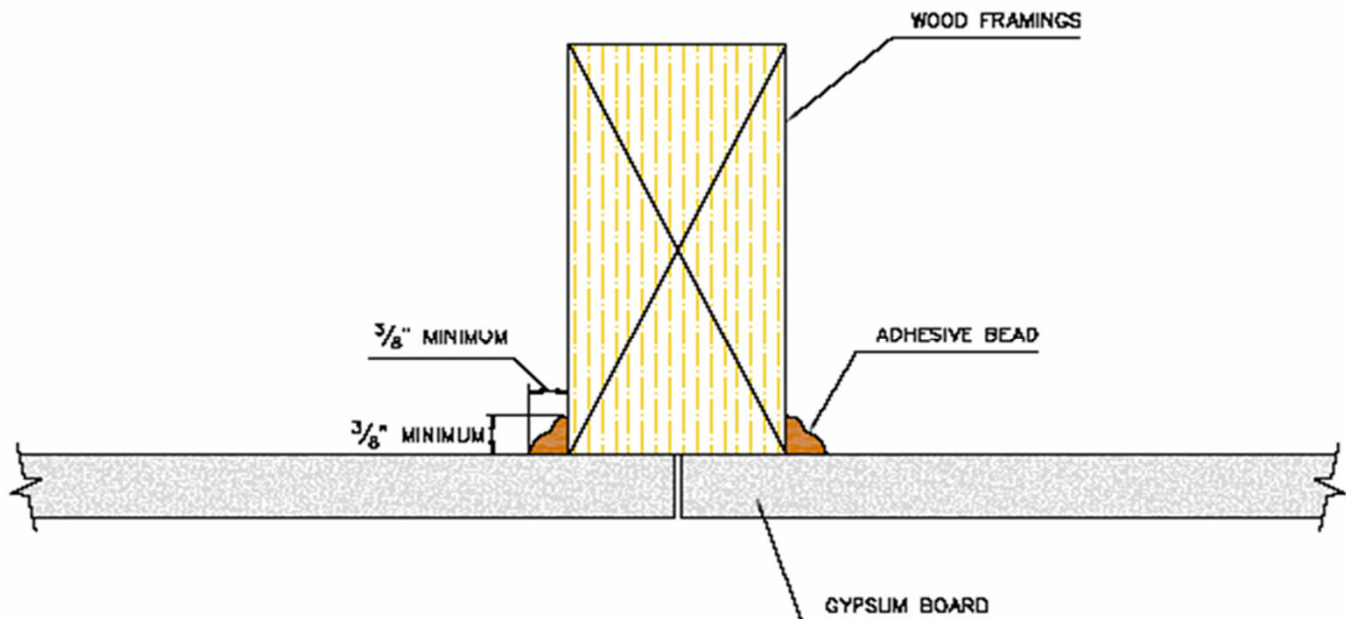

FIGURE 1: Ceiling use bead sizes

Product Labeling

Each cylinder shipped of **Voramers MB 3022** that is covered by this **PER** must have a label attached with at least the following information:

- | | |
|--|---|
| 1. The Dow Chemical Company Name and Address | 4. This PER Number & the approved Evaluation marks as noted below. |
| 2. Date of manufacture or Lot No. | 5. Component name |
| 3. Expiration Date | 6. A or B Designation (color coded - Red for Isocyanate. Blue for Polyol) |

Acceptable Evaluation Marks**Product Documentation**

A Product Evaluation Service Agreement between **Pei Evaluation Service®** and [The Dow Chemical Company](#)

A Follow-up Inspection Service Agreement between *Progressive Engineering Inc.* and [The Dow Chemical Company](#)

Voramers™ Industrial Adhesive User Instructions

A SDS sheet for **Voramers™ MB 3022** Polyol - Dated: 8/31/2021

A SDS sheet for **Voramers™ ME 3044** Isocyanate - Dated: 8/05/2020

Opinion Letters Dated: July 24, 2000 April 16, 2001 April 15, 2005

Ceiling Diaphragm Test Reports

A *PEI* test report no. 2000-0886 - Full Scale Cathedral Ceiling Diaphragm Test on an 11'-8" x 52'-0" Ceiling using Voramers™ MB 3022 / Voramers™ ME 3044 Adhesive - Revised: 2/1/2013

A *PEI* test report no. 2000-0887 - Full Scale Ceiling Diaphragm Test on an 15'-6" x 52'-0" Flat Ceiling using Voramers™ MB 3022 / Voramers™ ME 3044 Adhesive - Revised: 6/26/2001

A *PEI* test report no. 2000-0888 - Full Scale Cathedral Ceiling Diaphragm Test on an 15'-6" x 52'-0" Ceiling using Voramers™ MB 3022 / Voramers™ ME 3044 Adhesive - Revised: 6/26/2001

Ceiling Dead Load Test Reports

A *PEI* test report no. 2000-1032 - Ceiling Dead Load Test using Voramers™ MB 3022 / Voramers™ ME 3044 and 5/8" Gypsum - Revised: 6/26/2001

A *PEI* test report no. 2000-1502 - Ceiling Dead Load Test using Voramers™ MB 3022 / Voramers™ ME 3044 and 5/8" Gypsum - Revised: 6/26/2001

Ceiling Sag Test Report

A *PEI* test report no. 2001-0955(D) - Ceiling Sag Test using 1/2" American Gypsum and Voramers™ MB 3022 / Voramers™ ME 3044 Two-Part Adhesive - Dated: 6/18/2001

PEI Standard No. 93-7 Test Report

A *PEI* test report no. 2000-1501 - PEI Standard No. 93-7 Test on Voramers™ MB 3022 / Voramers™ ME 3044 Adhesive - Revised: 6/26/2001

ASTM E84 Test Report

A test report file no. FH-1321 - Surface Burning Characteristics ASTM E84-01 Dow Chemical Corporation - Voramers MB 3022 / Voramers ME 3044 - Dated: 6/4/2002

UL-1715 Test Reports

A test report no. RCB 0305 - UL-1715 Fire Test of Interior Finish Material - using 3/8" Gypsum - The Dow Chemical Company - Dated: 11/13/2003

A test report no. RCB 0303 - UL-1715 Fire Test of Interior Finish Material - using 1/2" Gypsum - The Dow Chemical Company - Dated: 11/12/2003

A test report no. RCB 0502 - UL-1715 Fire Test of Interior Finish Material - using 5/8" Gypsum - The Dow Chemical Company - Dated: 5/4/2005